

EH230 Series Emergency Hatches (metric)

Liquip offers a unique 225mm (9") aluminium emergency inspection hatch with a quick opening lid that doubles as an emergency vent with pressure/vacuum relieving vent and rollover protection. Now supplied in metric.



EH230 series emergency hatches.

Features and Benefits

- Easy to open.
- Two stage opening for added safety.
- Operates as an emergency vent.
- Incorporates a standard Liquip pressure vacuum vent for thermal relief of the tanker (optional).
- Supplied as a complete unit ready for fitting to a tanker or storage tank.
- A wide variety of seals are available depending on the product being stored or transported.

Technical Information

Standards	Complies with Australian Standard AS2809:2020 and pressure settings of EN14595.
2 stage opening	For safety the hatch has a two-stage opening and also acts as an emergency vent. Supplied as a complete assembly.
Pressure and Capacity	For emergency vent opening pressure refer below Emergency Vent capacity: 8,500 m ³ /hr @ 45 kPa.
Coaming and Seals	The Weld-in coaming is available in aluminium or mild steel. Wide variety of seals available to suit various applications & products.
Pressure Vacuum Vents	Optional pressure & vacuum vent can be incorporated. For opening pressure & capacity see PVV104M series datasheet.
Dismantle	Bridge & handle may be taken off by removing e-clips from pivot pins & removing pivots.
Adjustment or Service	Periodically check the seals, check emergency vent for correct opening pressure.
Materials of Construction	Vent cover, bridge and handle: Aluminium Seals: Nitrile (as standard) or Viton (on request as listed in drawing overleaf). Coamings: Aluminum or Mild Steel
Mounting	Coamings are mounted directly into tanker walkway.
Weight	6.0 Kg.

Ordering Information

EH230 - A - 6A - 8A

COAMING MATERIAL

- A = Aluminium
- M = Mild Steel
- S = Stainless Steel

EMERGENCY VENT

- 6A = Nitrile main seal [Opens at 30kPa, Capacity: 8,500m³/hr at 45kPa] Use only with PVV104M.
- 6AV = Viton™ main seal [Opens at 30kPa, Capacity: 8,500m³/hr at 45kPa] Use only with PVV104M.
- 6U = Nitrile main seal [Opens at 30kPa, Capacity: 8,500m³/hr at 45kPa] Use only with PVV104UM.
- 6UV = Viton™ main seal [Opens at 30kPa, Capacity: 8,500m³/hr at 45kPa] Use only with PVV104UM.
- 6AVG = Nitrile main seal [Opens at 30kPa, Capacity: 8,500m³/hr at 45kPa] Use only with PVV104M.
- 6AVVG = Viton™ main seal [Opens at 30kPa, Capacity: 8,500m³/hr at 45kPa] Use only with PVV104M.
- 6B = Nitrile main seal [Opens at 24kPa, Capacity: 8,500m³/hr at 45kPa] Use only with PVV104UM.

PVV VENT

- 80 = Blanking plate
- 8A = PVV104M – Australia/NZ [opens at 10 to 17kPa pressure / 0 to -4 kPa vacuum, Capacity: 98m³/hr at 35 kPa].
- 8U = PVV104UM - International [opens at 8 to 12kPa pressure / -0.4 to -2.5 kPa vacuum, Capacity: 91m³/hr at 30 kPa].
- 8N = No PVV104 fitted.

Coamings

- **EH230-1M:** steel coaming hole required: approx Ø245mm
- **EH230-1A:** aluminium coaming 6060 T5 alloy hole required: approx Ø245mm

EH230 METRIC EMERGENCY HATCH ASSEMBLIES

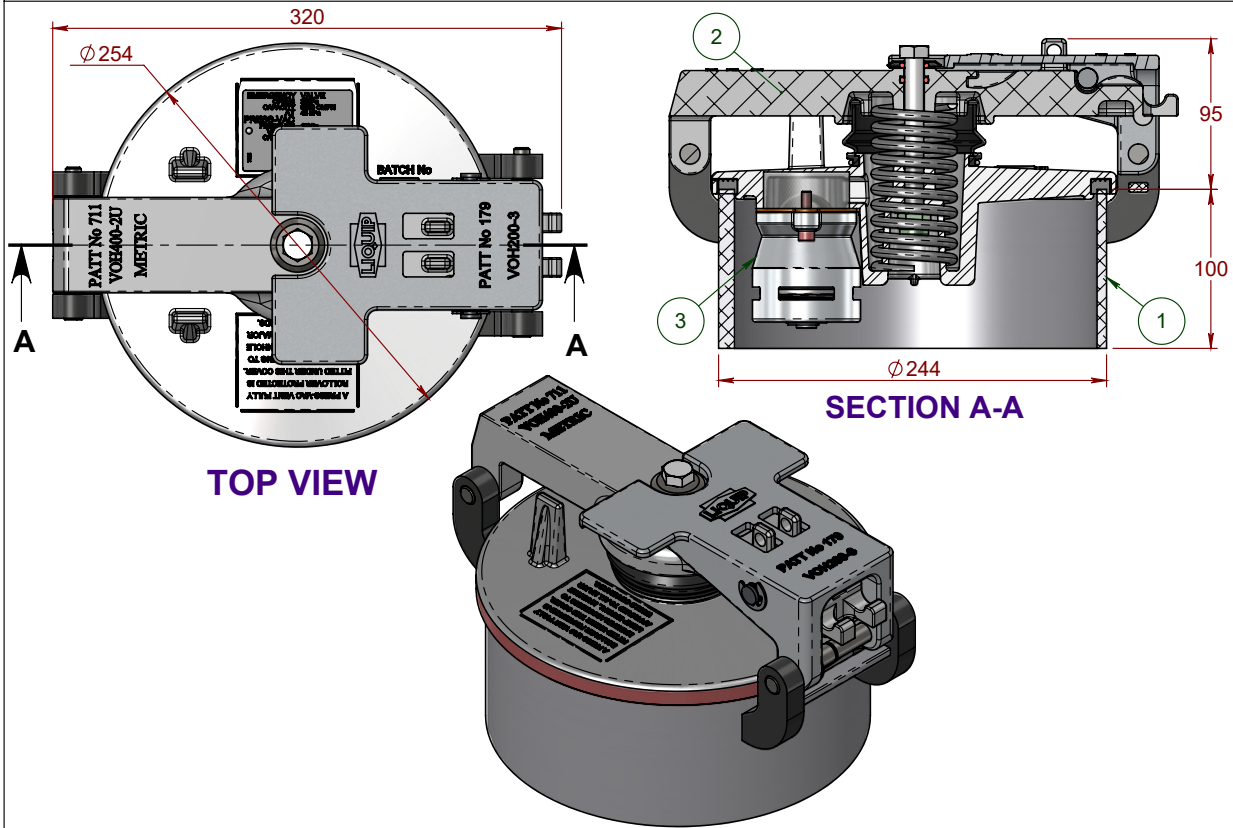

ITEM	PART NUMBER	DESCRIPTION	DESCRIPTION (CONT')	MATERIAL
1	EH230-1A	COAMING ASSEMBLY 100MM HIGH	9" EMERGENCY HATCHES	ALUMINIUM
	EH230-1M	COAMING ASSEMBLY 100MM HIGH	9" EMERGENCY HATCHES	STEEL
	EH231-1A	COAMING ASSEMBLY 60MM HIGH	9" EMERGENCY HATCHES	ALUMINIUM
	EH230-1S	COAMING ASSEMBLY 100MM HIGH	9" EMERGENCY HATCHES	ST STEEL
2	VOH501-32A	EMERGENCY VENT, PLAIN BRIDGE AND HANDLE	AUSTRALIAN SPRING & LABEL	ALUMINIUM & NITRILE
	VOH501-32AV	EMERGENCY VENT, PLAIN BRIDGE AND HANDLE	AUSTRALIAN SPRING & LABEL	ALUMINIUM & VITON
	VOH501-32AVG	EMERGENCY VENT, PLAIN BRIDGE AND HANDLE	AUSTRALIAN SPRING & LABEL	ALUMINIUM & NITRILE & VITON GFLT
	VOH501-32U	EMERGENCY VENT, PLAIN BRIDGE AND HANDLE	INTERNATIONAL SPRING & LABEL	ALUMINIUM & NITRILE
	VOH501-32UV	EMERGENCY VENT, PLAIN BRIDGE AND HANDLE	INTERNATIONAL SPRING & LABEL	ALUMINIUM & VITON
	VOH501-32LP	EMERGENCY VENT, PLAIN BRIDGE AND HANDLE	LOW PRESSURE, SUITS AVIATION COLLECTOR TANKS	ALUMINIUM & NITRILE & VITON
	VOH501-32AVVG	EMERGENCY VENT, PLAIN BRIDGE AND HANDLE	AUSTRALIAN SPRING & LABEL	ALUMINIUM & VITON & VITON GFLT
3	PVV104-2	BLANKING PLATE	WHEN NO PVV FITTED	ALUMINIUM
	PVV104M	PRESSURE AND VACUUM VENT	AUSTRALIAN/NZ MODEL	ALUMINIUM
	PVV104UM	PRESSURE AND VACUUM VENT	INTERNATIONAL MODEL	ALUMINIUM

METERS - VALVES - VENTS - MANHOLES - HOSEREELS - OVERFILL PROTECTION - LOADING ARMS - ELECTRONIC DIPSTICKS



LIQUIP INTERNATIONAL PTY LTD

148B NEWTON RD, WETHERILL PARK, SYDNEY N.S.W. AUSTRALIA 2164

Phone: +61 2 9725-9000

Web: www.liquip.com

X400021

Sheet 1 of 1
Issue: C

EH230 INSPECTION HATCH ASSEMBLIES

COAMING



EH230-A

EH230-1A
9" ALUMINIUM 100mm COAMING



EH231-A

EH231-1A
9" ALUMINIUM 60mm COAMING

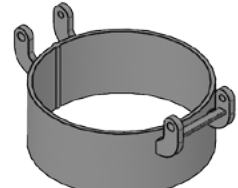

EH230-M

EH230-1M
9" MILD STEEL 100mm COAMING

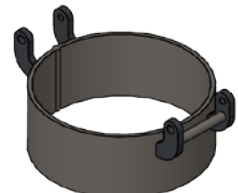

EH230-S

EH230-1S
9" STAINLESS STEEL (316) 100mm COAMING

THIS ITEM NOT STOCKED
MADE TO ORDER ONLY

EMERGENCY VENT, BRIDGE & HANDLE

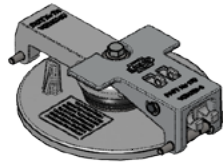

6A

VOH501-32A
EMERGENCY VENT,
ALUMINIUM BRIDGE & PLAIN HANDLE,
NITRILE SEAL, AUST LABEL SUB-ASSEMBLY

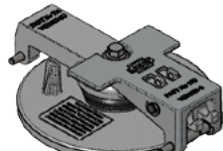

6AV

VOH501-32AV
EMERGENCY VENT
ALUMINIUM BRIDGE & PLAIN HANDLE
VITON SEAL, AUST LABEL SUB-ASSEMBLY

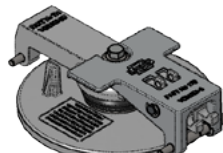

6U

VOH501-32U
EMERGENCY VENT,
ALUMINIUM BRIDGE & PLAIN HANDLE
NITRILE SEAL, LABEL SUB-ASSEMBLY



6UV

VOH501-32UV
EMERGENCY VENT,
ALUMINIUM BRIDGE & PLAIN HANDLE
VITON SEAL, LABEL SUB-ASSEMBLY

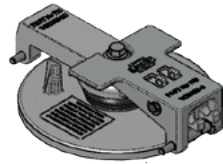

6AVG

VOH501-32AVG
EMERGENCY VENT
ALUMINIUM BRIDGE & PLAIN HANDLE
NITRILE SEAL, VITON GFLT O-RINGS, AUST
LABEL SUB-ASSEMBLY

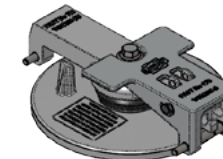

6AVVG

VOH501-32AVVG
EMERGENCY VENT
ALUMINIUM BRIDGE & PLAIN HANDLE
VITON SEAL, VITON GFLT O-RINGS, AUST
LABEL SUB-ASSEMBLY

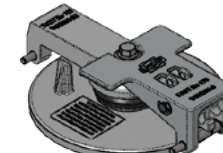

6LP

VOH501-32LP
EMERGENCY VENT,
LOW PRESSURE SPRING
ALUMINIUM BRIDGE & PLAIN HANDLE
NITRILE SEAL, VITON O-RING,
NO LABEL SUB-ASSEMBLY
THE STATEMENT "A PRESS-VAC VENT... IS
FITTED..." TO BE REMOVED.
NON COMPLIANT WITH AS2809

PRESSURE & VACUUM VENT



8O

PVV104-2
BLANKING PLATE
4250 GASKET NBR CORK
5269 WASHER SPRING
55024 CAPSCREW M6 x 25



8A

PVV104M
(AUSTRALIA)



8U

PVV104UM
(INTERNATIONAL)

NO PVV104 FITTED

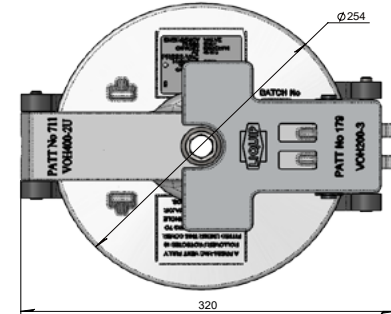

TOP VIEW

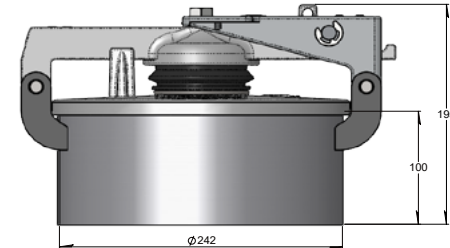

FRONT VIEW

METRIC ASSEMBLY NUMBERS:

EXAMPLE: EH230-A-6A-8A

COAMING LENGTH _____
 COAMING MATERIAL _____
 EMERGENCY VENT SUB-ASSY _____
 PVV VENT OR BLANKING _____

NOTE: SPECIAL ALL STAINLESS STEEL INSPECTION HATCH
 AVAILABLE, MADE TO ORDER
 SEE PART No. EH230-SS-B

REV.	REVISION DESCRIPTION	BY	DATE	MDC REF
C	ADDED COAMING HEIGHTS, PVV104 8U, AND 6AVVG-HLP CONFIGURATIONS	MR	5/06/2023	23-011 23-003
B	REMOVED "UK" AND ADDED "INTERNATIONAL"	HT	28-Sep-21	20-022
A	ORIGINAL ISSUE	DT	26/08/2020	19-027

DRAWING TITLE: EMERGENCY HATCH 9" INSPECTION OPENING		LIQUIP PART	
MATERIAL:	SEE TABLE	DRAWN:	17/3/03
HEAT TREATMENT:	NONE	ISSY DWG:	N/A
PROTECTIVE TREATMENT:	NONE	PART No:	N/A
REMOVE ALL SHARP EDGES AND BURRS		SCALE:	1:3
FINISHES:		MASS:	6.23
DRILL:	4.25	DRAWN BY:	DT
DRILL:	4.25		
SURFACE FINISH:	1.0um		
WAXED DRAFT:	1.0um		
FILET RADIUS:	25mm		
THIS IS CONFIDENTIAL INFORMATION		IF IN DOUBT, ASK!	
THIS DRAWING AND DESIGN IS THE PROPERTY OF LIQUIP INTERNATIONAL PTY LTD. IT MUST NOT BE COPIED OR REPRODUCED IN ANY WAY WHATSOEVER AND/OR PASSED ON TO ANY THIRD PARTY WITHOUT WRITTEN AUTHORITY.		DO NOT SCALE OFF DRAWING	
Drawing file: I:\open\sys\003\server\global\net\engineering\img\img\EH230 ASSEMBLY\EH230-SS-B.dwg		Sheet 1 of 2	
Model file: I:\open\sys\003\server\global\net\engineering\img\img\EH230 ASSEMBLY		DRAWING NO. ISSUE	
		E55020 C	